

FRONT VIEW

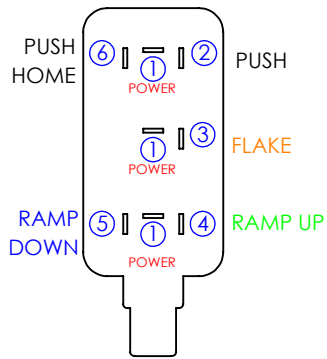

BACK VIEW



**THE LABELED SWITCH
FUNCTION ENERGIZES
THE OPPOSITE CONDUCTOR*
LOCATED ON BACK.**

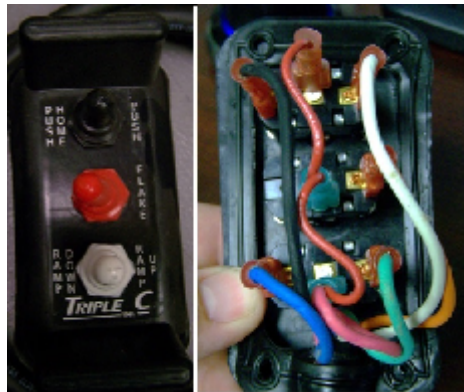

6 PIN/SOCKET PLUG		
PIN POSITION #	MAIN CABLE CONDUCTOR* COLOR	SWITCH FUNCTION
1	RED	POWER
2	WHITE	PUSH
3	ORANGE	FLAKE
4	GREEN	RAMP UP
5	BLUE	RAMP DOWN
6	BLACK	PUSH HOME

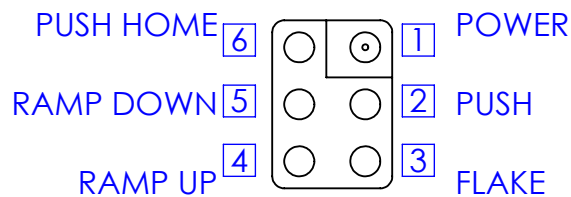

REVISIONS		DATE	APPROVED
REV.	DESCRIPTION		
	UPDATED CABLE LENGTH FROM 8FT TO 12FT	12/20/11	
A	CHANGED TO DEUTSCH CONNECTOR FROM FEMALE 6 PIN/SOCKET CONNECTOR. UPDATED TO NEW DRAWING FROM HFL-900	8/8/2012	
B	DECIDED TO STAY WITH THE FEMALE 6 PIN/SOCKET CONNECTOR	9/26/2013	
C	STANDARDIZED SOCKET PLUG NUMBERS	11/19/2015	

*** CABLE CONDUCTOR COLORS
SUBJECT TO CHANGE.
CONFIRM PLUG PIN POSITION #
TO SWITCH TERMINAL #**

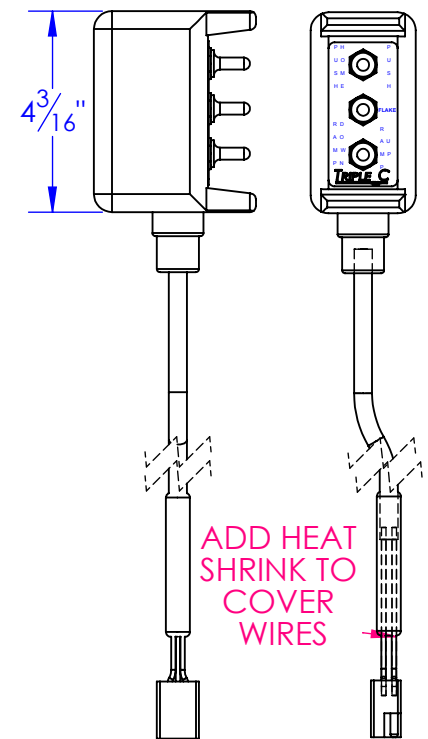
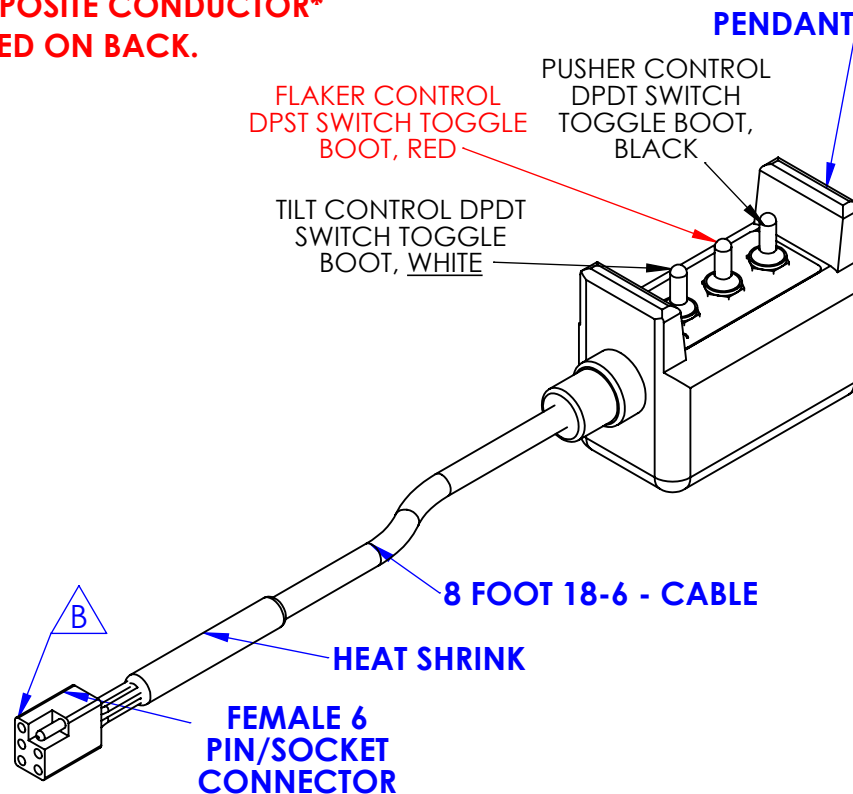
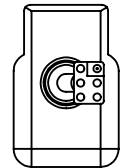

P.O. BOX 248,
SABETHA, KS 66534

TRIPLE C
INC.

DIMENSIONS ARE IN INCHES TOLERANCES: FRACTIONAL $\pm 1/16$ ANGULAR: MACH ± 1 BEND \pm TWO PLACE DECIMAL ± 010 THREE PLACE DECIMAL ± 005		NAME	DATE
DRAWN		CAITLYN	1/15/2016
PART #		EL-HFL-911	
ASM #			
COMMENTS:		FLAKER SWITCH PENDANT SECTION	
MATERIAL		---	
DO NOT SCALE DRAWING			

PROPRIETARY AND CONFIDENTIAL
THE INFORMATION CONTAINED IN THIS
DRAWING IS THE SOLE PROPERTY OF TRIPLE
C INC. ANY REPRODUCTION IN PART OR
AS A WHOLE WITHOUT THE WRITTEN
PERMISSION OF TRIPLE C INC. IS PROHIBITED.

SIZE	DWG. NO.	REV.
A	40-1900 C	C
SCALE: 1:3	WEIGHT: --	SHEET 1 OF 1